

**Thomas & Betts**

**Meet NEC® Article 250.52 Requirements  
for Rebar Grounding!**

**Now UL® Listed  
for Use with  
#4 Rebar!**

**Blackburn®**

G5 Direct-Burial Rebar  
Grounding Clamp



# Blackburn®

## G5 Direct-Burial Rebar Grounding Clamp

### Now UL® Listed for Grounding #4 Rebar in Direct-Burial or Concrete-Encased Applications!

With its new UL Listing for use with 1/2" rebar, the Blackburn® G5 Grounding Clamp makes it easy to comply with National Electrical Code® Article 250.52 requirements for grounding to rebar in the footings of new residential, commercial and institutional buildings. The simple, compact and corrosion-resistant design provides a lasting, trouble-free and cost-effective grounding connection.

- Made from high-strength, corrosion-resistant silicon-bronze copper alloy with stainless steel hex-head bolt
- Designed for a recommended torque of 300 in.-lbs.
- UL Listed for use on 1/2" and 5/8" copper-coated and galvanized ground rods and #4 (1/2") rebar, buried in earth or concrete.
- UL 467, CSA C22.2 No. 41-07, RUS Listed

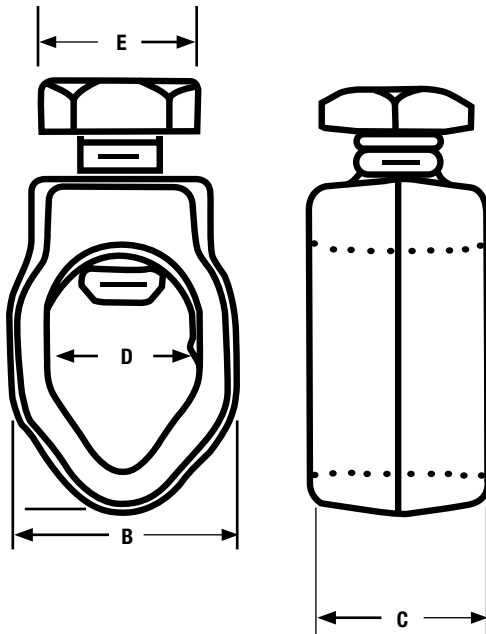

### Blackburn® G5 Direct-Burial Rebar Grounding Clamp

Cat. Number	Rebar Size	Rod Dia. (in.)	Wire Range (AWG)	Dimensions (in.)				Std. Pkg. Qty.	UPC Number
				B	C	D	E		
G5*	#4 (1/2")	1/2-5/8	10 Sol. - #2 Str.	29/32	3/8	49/64	1/2	50	783786-80067

\*This connector is not listed by CSA to be used with #4 rebar.

[www.tnb.com](http://www.tnb.com)

**Thomas & Betts**

Please ask your Thomas & Betts sales representative for a complete catalog of quality Thomas & Betts electrical products or visit us at [www.tnb.com](http://www.tnb.com). For customer service, call 1-800-816-7809. For technical questions, call 1-888-862-3289.

**Thomas & Betts Corporation**  
Electrical Division  
8155 T&B Boulevard  
Memphis, TN 38125  
901-252-5000

**Thomas & Betts Ltd.**  
700 Thomas Avenue  
Iberville, Québec J2X 2M9  
450-347-5318